

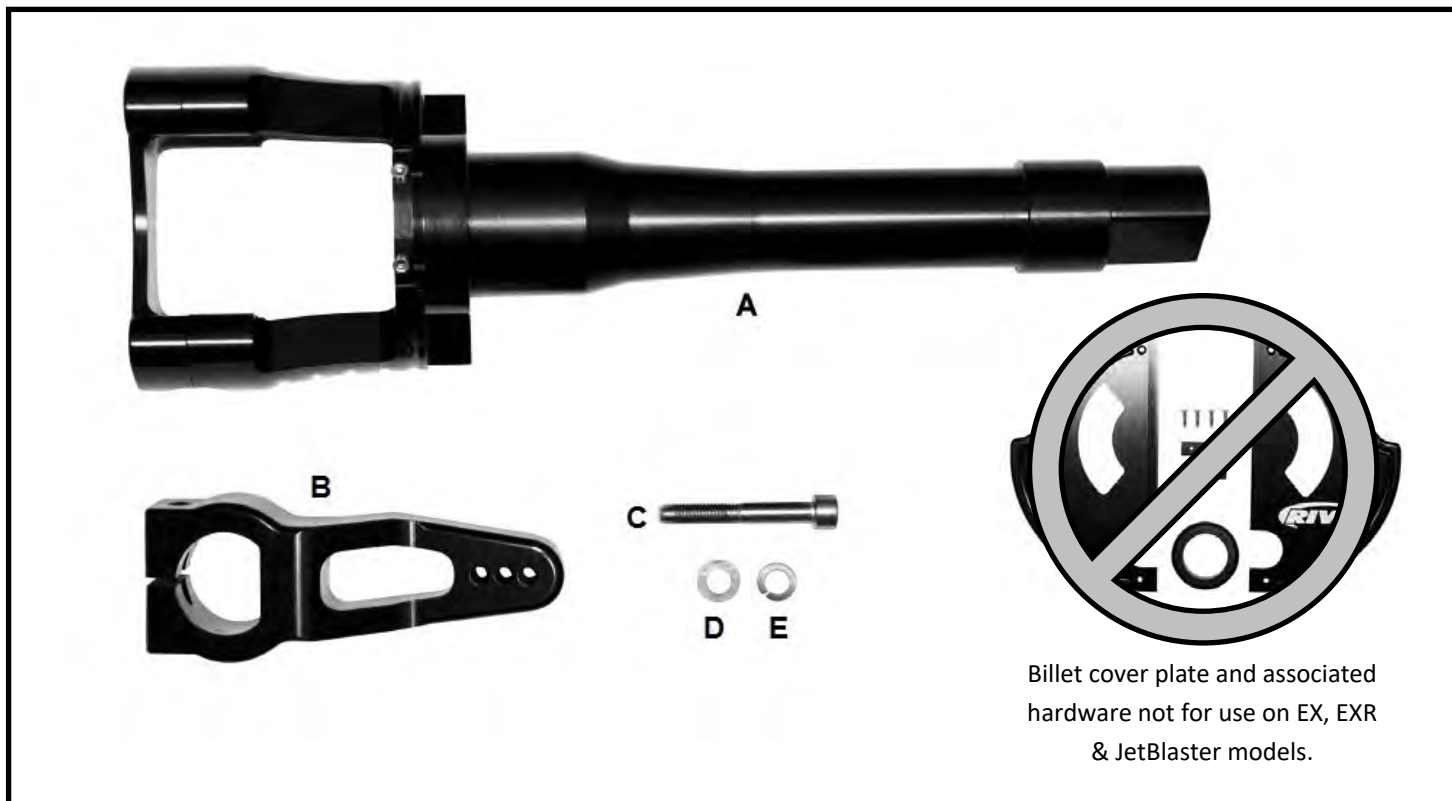

**RIVA RACING**  
PERFORMANCE PRODUCTS & ACCESSORIES

## Yamaha EX/EXR/JetBlaster Steering Kit

RY20110



### Applications:

Yamaha EX/EXR/JetBlaster 2017~24

### Approximate Installation Time:

1.0 hr

### Recommended Specialty Tools:

None

### Part #

N/A

### Required Materials:

Red Loctite

### Part #

N/A

We strongly recommend the use of a service manual to familiarize yourself with the various components and procedures involved with this installation. Please note that some of the original hardware removed in the disassembly process will be used in the installation process. These instructions have been written in step-by-step format and refer to illustrations. Read through instructions entirely before performing installation. Please follow these step-by-step instructions and illustrations carefully.

**\*\*\* ALLOW ENGINE TO COOL COMPLETELY BEFORE PERFORMING INSTALLATION \*\*\***

**\*\*\* NO SMOKING \*\*\* NO SMOKING \*\*\* NO SMOKING \*\*\***



**RIVA RACING**  
PERFORMANCE PRODUCTS & ACCESSORIES

**Yamaha EX/EXR/JetBlaster Steering Kit**

*RY20100*

**COMPONENT LIST**

ITEM	QUANTITY	PART NUMBER	DESCRIPTION
A	1		Steering Shaft
B	1		Steering Arm
C	1	051.8.55	8 x 55 mm SHCS
D	1	369023SS	8 mm Flat Washer
E	1	447.8	8 mm Lock Washer

our kit was inspected and verified before being carefully packaged by our staff. Please check package contents before beginning assembly. If you have a question about missing or damaged items please contact RIVA Technical Support directly at (954) 247-0705 or by e-mail at [tech\\_support@rivaracing.com](mailto:tech_support@rivaracing.com).

## - INSTALLATION INSTRUCTIONS -

Open front storage compartment lid to fully open position. Pull lid directly away from ski to remove lid from plastic hinge. (Figure 1)

Figure 1



Press in on center pin of plastic rivets with screwdriver or similar object and remove plastic rivets and storage tray. **Note: Do not push too far or center pin will fall into storage compartment.** (Figure 2)

Figure 2



Remove socket head screws and washers (2) retaining grips at end of handlebar. (Figure 3)

Figure 3



Remove (2) inner grip screws (A), and (6) steering cover screws (B). Figure (4)

Figure 4

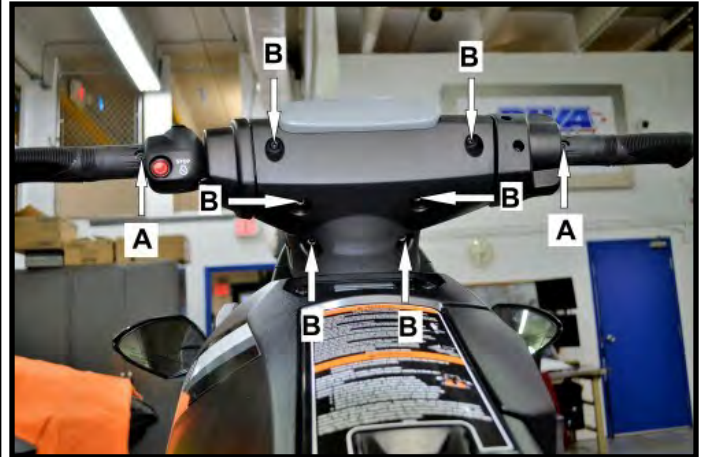

Release the two catches at the sides of the steering cover and remove the steering cover. (Figure 5)

Figure 5



Remove the screws securing the controls to the handlebar. (Figures 6,7 and 8)

Figure 6

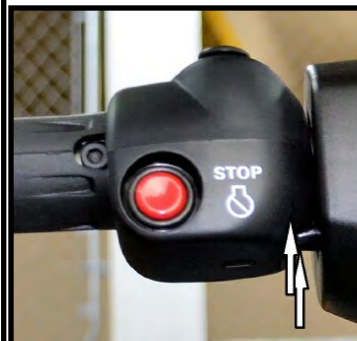

Figure 7

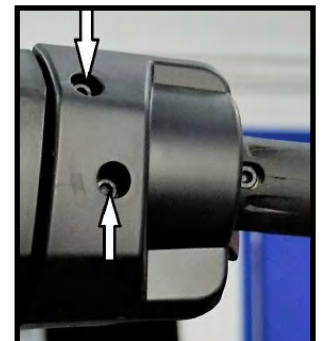

Figure 8





## **- INSTALLATION INSTRUCTIONS -**

Remove grips. Open control housings and remove control housing locating screws (2). Remove controls from bar. (Figure 9)

Figure 9

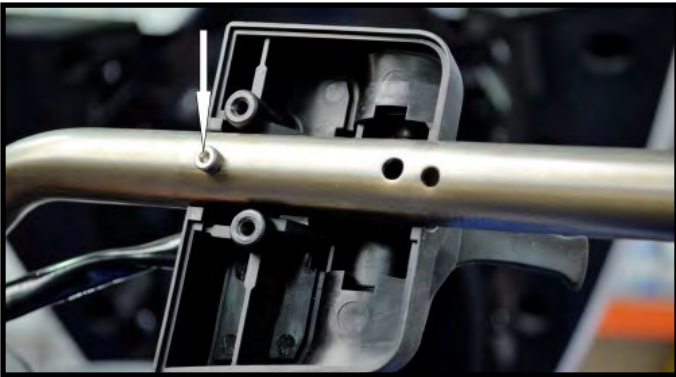

For models not equipped with ride only remove screw retaining left control shroud. (Figure 10)

Figure 10



Remove bolts(4) in handlebar clamps and remove handlebar and left control shroud. (Figure 11)

Figure 11



Inside front of ski grasp spring loaded cover of steering cable ball joint and push in direction shown while lifting off ball stud on steering arm. (Figure 12)

Figure 12

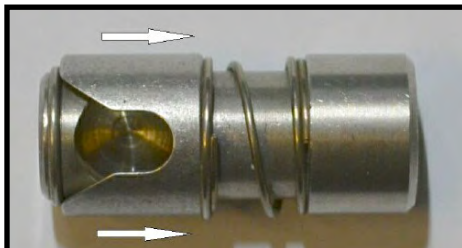

Bend down locking tabs and remove bolt from steering arm. (Take care not to drop nut into hull.) Remove steering arm from steering shaft. (Figure 13)

Figure 13



Remove steering shaft from craft. Remove supplied steering arm from supplied steering shaft. Transfer magnets (A) and bushing (B) to supplied steering shaft. **Use red Loctite on magnet screws.** (Figure 14)

Figure 14

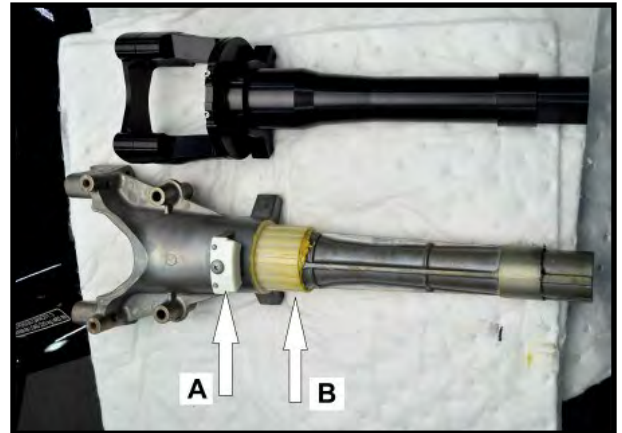

Trim 1/16" (1.5mm) from each of the flanges in the steering support as shown. (Figure 15). **Tip: A sharp utility knife will work to trim these flanges.**

Figure 15



## **- INSTALLATION INSTRUCTIONS -**

Apply waterproof grease to steering shaft bushing. Insert RIVA steering shaft into steering support.

Remove ball stud from OEM steering arm. Transfer to supplied steering arm as shown. **Install with red Loctite.** OEM locknut is not used. Apply waterproof grease to ball. **Note: three positions are provided for installation. Center position duplicates OEM steering. Installing ball stud closer to shaft enables faster steering response farther out enables slower steering response.** (Figure 16)

Figure 16



Install steering arm onto end of steering shaft. (Figure 17)  
**Note: Steering arm locates shaft vertically. Arm should fit snugly against lower steering bushing to prevent up and down motion of steering shaft. Shaft should turn freely.**

Install supplied M8x55 SHCS with M8 flat washer and M8 lock washer. **Torque to 15lb-ft/20N-m.** Attach steering cable to ball stud on steering arm. (Figure 17)

Figure 17



Install aftermarket handlebars & grips (not supplied in kit) and original controls.

Adjust steering cable if needed to center handlebars.

Replace parts previously removed to access steering.

Run craft on a flush kit to check for proper operation.

***Remember, the water belongs to everyone.***

***Please ride responsibly and respect the environment!***

### **Technical Support**

For answers to questions regarding installation or trouble shooting RIVA Performance Products contact:

RIVA Technical Support directly at (954) 247-0705 or by e-mail at [tech\\_support@rivaracing.com](mailto:tech_support@rivaracing.com).

### **Limited Warranty**

RIVA Steering Kits carry a 1-year limited warranty to the original purchaser. They are warranted to be free of defects in materials and workmanship under normal use and service. Customer modified components will be void of warranty. This warranty is limited to defects in the primary components only. Finish and/or wear marks in or on primary components are not covered under this warranty.

RIVA Racing's liability is expressly limited to the repair or replacement of the components contained within or associated with this kit. RIVA Racing agrees to repair or at RIVA's option, replace any defective unit without charge, if product is returned to RIVA Racing freight prepaid within the warranty period. Any equipment returned which, in RIVA's opinion, has been subjected to misuse, abuse, overheating or accident shall not be covered by this warranty.

RIVA Racing shall have no liability for special, incidental or consequential damages or injury to persons or property from any cause arising from the sale, installation or use of this product.

No other warranty, express or implied, including, but not limited to the implied warranties of merchantability and fitness for a particular purpose, applies. Various states do not allow for the limitation of incidental or consequential damages and therefore the above exclusion or limitation may not apply to you.

Warranty does not include the expenses related to freight or transportation of parts or compensation for any inconvenience or loss of use while being repaired. A copy of the original invoice and a Return Authorization Number (RA#) must accompany all warranty claims.

Warranted replacement parts will be returned freight collect.